

F3 F4 нагреваемая сторона: F3 вход, F4 выход

F1 F2 греющая сторона: F1 вход, F2 выход

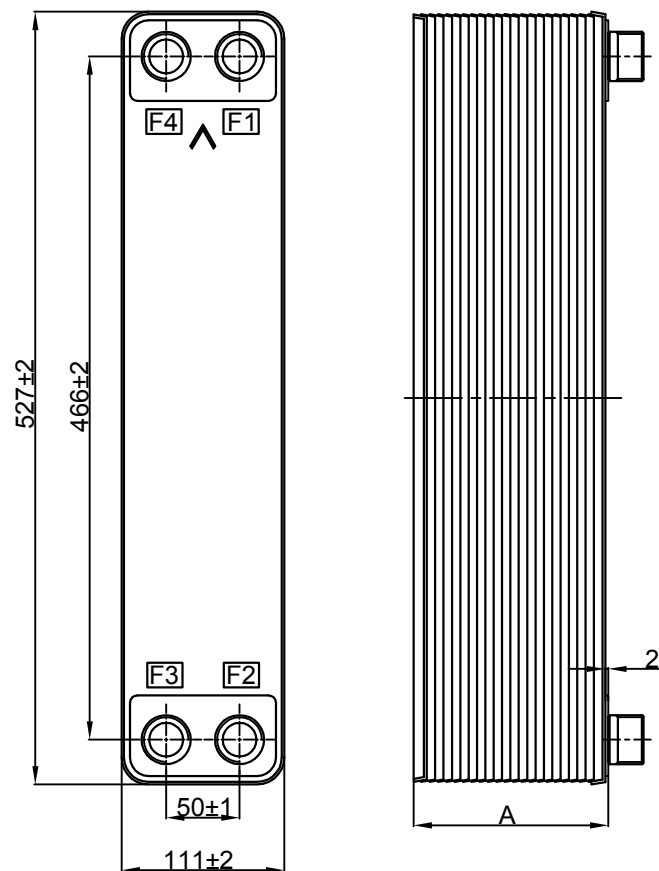

G1" Connection(L014)

F1 F2
F3 F4

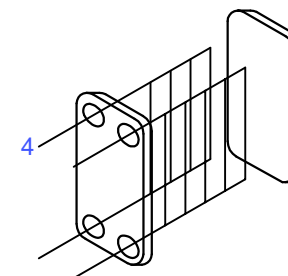
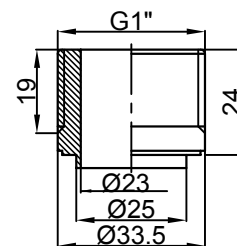

Design pressuer(MPa)	3.0
Testing pressuer(MPa)	4.5
Design Temperature(°C)	-196~+200°C
Label Code	
Plate material	316L

FHT5433-030		SNB052-70-3.0-H	171±3	F1F2side:3.29 ;F3F4side:3.20	14.04	3.54
FHT5433-029		SNB052-60-3.0-H	148±3	F1F2side:2.82 ;F3F4side:2.73	12.42	3.02
FHT5433-028		SNB052-50-3.0-H	126±3	F1F2side:2.35 ;F3F4side:2.26	10.8	2.50
FHT5433-027		SNB052-40-3.0-H	103±2	F1F2side:1.88 ;F3F4side:1.79	9.18	1.98
FHT5433-026		SNB052-30-3.0-H	80±2	F1F2side:1.41 ;F3F4side:1.32	7.56	1.46
FHT5433-025		SNB052-20-3.0-H	57±2	F1F2side:0.94 ;F3F4side:0.85	5.94	0.94
FHT5433-024		SNB052-10-3.0-H	35±2	F1F2side:0.47 ;F3F4side:0.38	4.32	0.42
Drawing No.	Customer Part No.	Plate No.	A(mm)	Volume(L)	Weight (kg)	Heat transfer area(m ²)

Connection vertical degree: ±2°

Mark No.	Change file No	sign	Date
Design	XUZH	Standard	
Check		Approved	
Review		Edition	A/0
Process		Date	20211022

View	Scale	Size
	1:2	



Brazed Plate Heat Exchanger

SNB052-N-3.0-H
F1F2F3F4(G1")

